

Overview:

Established in 2003, Riverlink is a network of land tracts and partnerships, providing this mid-coast peninsula with a wildlife corridor and trail system. The open space and greenway connect the Sheepscot and Damariscotta Rivers.

The River-Link Trail should be considered a back-country trail of moderate difficulty. Always carry water and first-aid supplies with you.

Guidelines:

- Please stay on the marked trail
- No overnight camping
- No open fires
- No motorized wheeled vehicles
- Carry in / Carry out



PARTNERS OF RIVER – LINK

Boothbay Region Land Trust

Damariscotta River Association

Maine Coast Heritage Trust

Maine Department of Conservation

Maine Department of Inland Fisheries and Wildlife

Maine Land For Maine's Future Program

Schmid Land Preserve

Sheepscot Valley Conservation Association

Town of Boothbay

Town of Edgecomb

Town of Newcastle

U.S. Fish and Wildlife Service

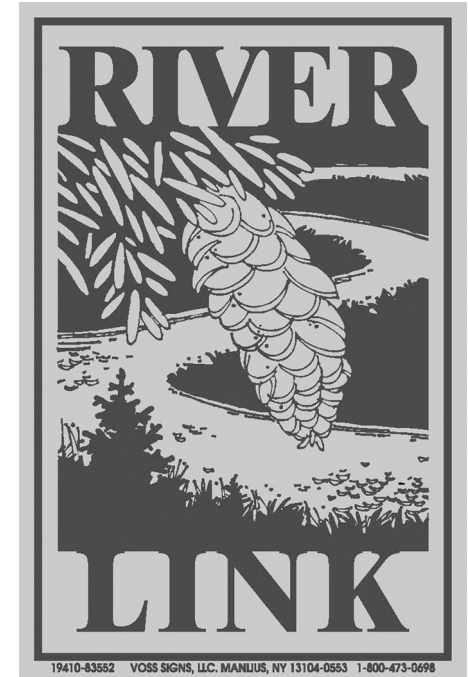

A TRAIL CONNECTING

THE
SHEEPSCOT
&
DAMARISCOTTA
RIVERS

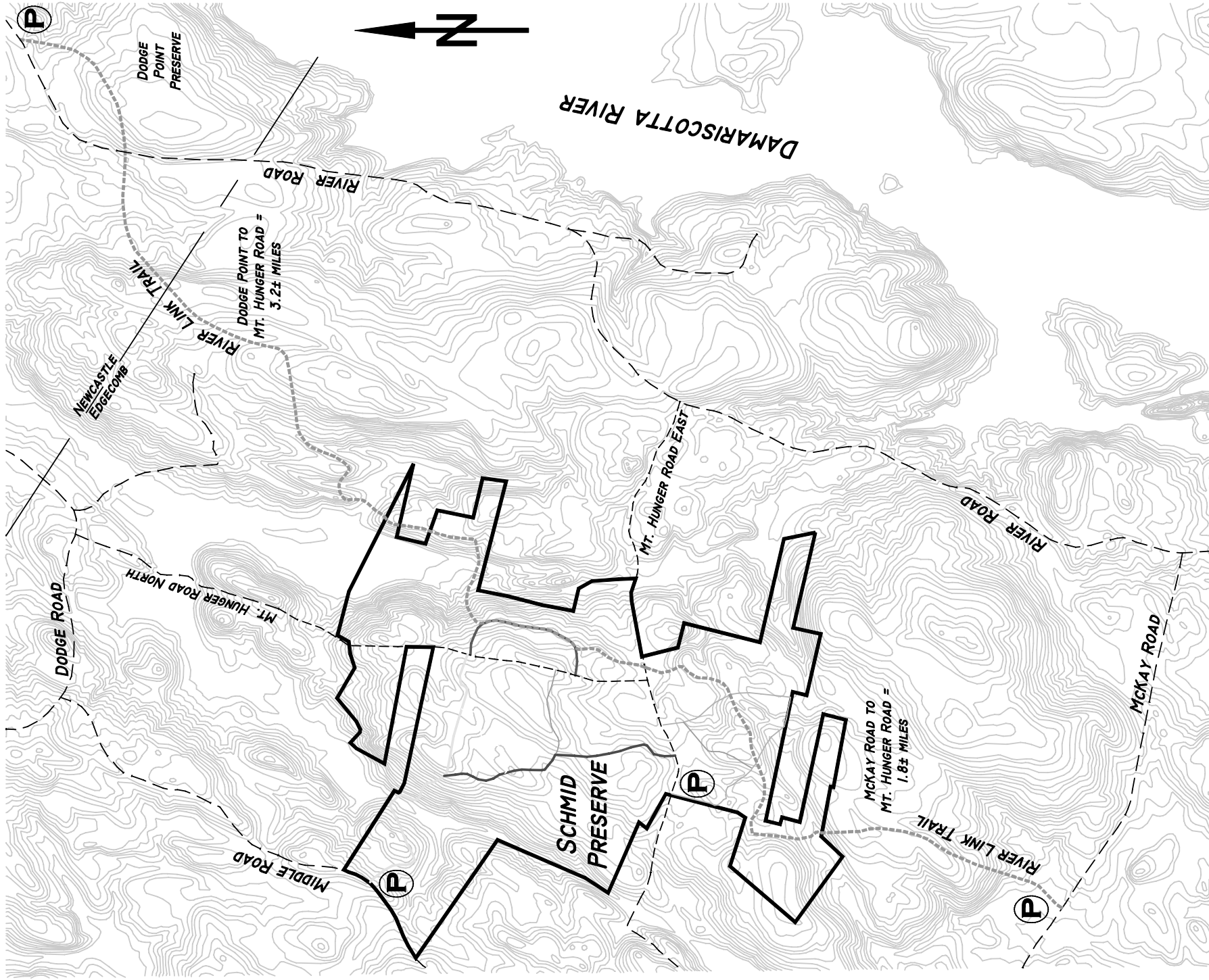

SCHMID PRESERVE - RIVER LINK TRAIL MAP

SCALE: 1"=2000'±

JULY 16, 2010